

ELEVATION CERTIFICATE

0170-07-0046
Important: Read the instructions on pages 1-8.

OMB No. 1660-0008
Expires February 28, 2009

07 732436 B1

SECTION A - PROPERTY INFORMATION

File # 06-07-11

For Insurance Company Use:

Building Owner's Name: HABITAT FOR HUMANITY SOUTH SARASOTA COUNTY, INC.
Policy Number

A2. Building Street Address (including Apt., Unit, Suite, and/or Bldg. No.) or P.O. Route and Box No.: 205 COLLINS ROAD
Company NAIC Number

City: NOKOMIS State: FLORIDA ZIP Code: 34275

A3. Property Description (Lot and Block Numbers, Tax Parcel Number, Legal Description, etc.): LOT 16, BLOCK F, LAUREL HILL; TPID # 0170-07-0046

A4. Building Use (e.g., Residential, Non-Residential, Addition, Accessory, etc.): RESIDENTIAL

A5. Latitude/Longitude: Lat. 27°-8.1' Long. 82°-27.3' Horizontal Datum: NAD 1927 NAD 1983

A6. Attach at least 2 photographs of the building if the Certificate is being used to obtain flood insurance.

A7. Building Diagram Number: 1

A8. For a building with a crawl space or enclosure(s), provide:
a) Square footage of crawl space or enclosure(s): N/A sq ft
b) No. of permanent flood openings in the crawl space or enclosure(s) walls within 1.0 foot above adjacent grade: N/A
c) Total net area of flood openings in A8.b: N/A sq in

A9. For a building with an attached garage, provide:
a) Square footage of attached garage: _____ sq ft
b) No. of permanent flood openings in the attached garage walls within 1.0 foot above adjacent grade: N/A
Total net area of flood openings in A9.b: N/A sq in

SECTION B - FLOOD INSURANCE RATE MAP (FIRM) INFORMATION

B1. NFIP Community Name & Community Number: SARASOTA COUNTY - 125144

B2. County Name: SARASOTA COUNTY

B3. State: FLORIDA

B4. Map/Panel Number	B5. Suffix	B6. FIRM Index Date	B7. FIRM Panel Effective/Revised Date	B8. Flood Zone(s)	B9. Base Flood Elevation(s) (Zone AO, use base flood depth)
125144-0239	D	9-3-82	5-1-84	A12	11

B10. Indicate the source of the Base Flood Elevation (BFE) data or base flood depth entered in item B9.
 FIS Profile FIRM Community Determined Other (Describe)

B11. Indicate elevation datum used for BFE in item B9: NGVD 1929 NAVD 1988 Other (Describe)

B12. Is the building located in a Coastal Barrier Resources System (CBRS) area or Otherwise Protected Area (OPA)? Yes No
Designation Date: _____ CBRS OPA

SECTION C - BUILDING ELEVATION INFORMATION (SURVEY REQUIRED)

C1. Building elevations are based on: Construction Drawings* Building Under Construction* Finished Construction
*A new Elevation Certificate will be required when construction of the building is complete.

C2. Elevations - Zones A1-A30, AE, AH, A (with BFE), VE, V1-V30, V (with BFE), AR, AR/A, AR/AE, AR/A1-A30, AR/AH, AR/AO. Complete items C2.a-g below according to the building diagram specified in item A7.
Benchmark Utilized: PLAT.BM # 170-F Vertical Datum: ELEVATION = 6.47' (NGVD 1929)
Conversion/Comments:

Check the measurement used.

a) Top of bottom floor (including basement, crawl space, or enclosure floor)	13.0	<input checked="" type="checkbox"/> feet <input type="checkbox"/> meters (Puerto Rico only)
b) Top of the next higher floor	N/A	<input checked="" type="checkbox"/> feet <input type="checkbox"/> meters (Puerto Rico only)
c) Bottom of the lowest horizontal structural member (V Zones only)	N/A	<input checked="" type="checkbox"/> feet <input type="checkbox"/> meters (Puerto Rico only)
d) Attached garage (top of slab)	N/A	<input checked="" type="checkbox"/> feet <input type="checkbox"/> meters (Puerto Rico only)
e) Lowest elevation of machinery or equipment servicing the building (Describe type of equipment in Comments)	11.7	<input checked="" type="checkbox"/> feet <input type="checkbox"/> meters (Puerto Rico only)
f) Lowest adjacent (finished) grade (LAG)	11.0	<input checked="" type="checkbox"/> feet <input type="checkbox"/> meters (Puerto Rico only)
g) Highest adjacent (finished) grade (HAG)	11.5	<input checked="" type="checkbox"/> feet <input type="checkbox"/> meters (Puerto Rico only)

SECTION D - SURVEYOR, ENGINEER, OR ARCHITECT CERTIFICATION

This certification is to be signed and sealed by a land surveyor, engineer, or architect authorized by law to certify elevation information. I certify that the information on this Certificate represents my best efforts to interpret the data available. I understand that any false statement may be punishable by fine or imprisonment under 18 U.S. Code, Section 1001.

Check here if comments are provided on back of form:

Certifier's Name: ROBERT B. STRAYER, JR. License Number: P.S.M. # 5027

Title: PROFESSIONAL LICENSED SURVEYOR Company Name: STRAYER SURVEYING & MAPPING, INC.

Address: 42 SHAMROCK BLVD City: VENICE State: FL ZIP Code: 34293

Signature: [Signature] Date: 06/27/08 Telephone: (941) 497-1290

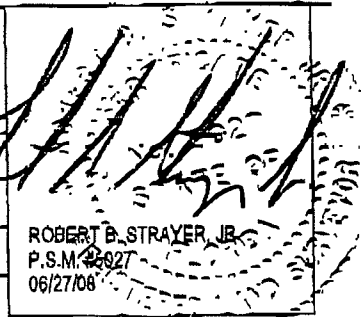

IMPORTANT: In these spaces, copy the corresponding information from Section A.			For Insurance Company Use:
Building Street Address (Including Apt., Unit, Suite, and/or Bldg. No.) or P.O. Route and Box No. 205 COLLINS ROAD			Policy Number
City NOKOMIS	State FLORIDA	ZIP Code 34275	Company NAIC Number

SECTION D - SURVEYOR, ENGINEER, OR ARCHITECT CERTIFICATION (CONTINUED)

Copy both sides of this Elevation Certificate for (1) community official, (2) insurance agent/company, and (3) building owner.

Comments FILE # 06-07-11 The subject parcel lies within 2 flood zones. An "A12" elevation 11' zone, and a "B" zone. A portion of the newly constructed house does fall within the "A12" zone. Based on the fill put in place for the foundation of the house and the lowest adjacent grade being above 11.0' the residence may be eligible for a conditional letter of map amendment "CLOMA" from FEMA. Upon filing with FEMA, mandatory flood insurance may no longer be required for this residence. Please call our office at 497-1290 for further details.

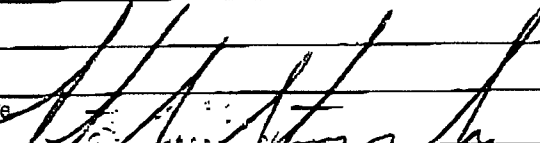
Signature  Date 06/27/08 Check here if attachments

SECTION E - BUILDING ELEVATION INFORMATION (SURVEY NOT REQUIRED) FOR ZONE AO AND ZONE A (WITHOUT BFE)

For Zones AO and A (without BFE), complete Items E1-E5. If the Certificate is intended to support a LOMA or LOMR-F request, complete Sections A, B, and C. For Items E1-E4, use natural grade, if available. Check the measurement used. In Puerto Rico only, enter meters.

- E1. Provide elevation information for the following and check the appropriate boxes to show whether the elevation is above or below the highest adjacent grade (HAG) and the lowest adjacent grade (LAG).
 - a) Top of bottom floor (including basement, crawl space, or enclosure) is _____ feet meters above or below the HAG.
 - b) Top of platform floor (including basement, crawl space, or enclosure) is _____ feet meters above or below the LAG.
- E2. For Building Diagrams B-8 with permanent flood openings provided in Section A Items 8 and/or 9 (see page 8 of Instructions), the next higher floor (elevation C2 b in the diagrams) of the building is _____ feet meters above or below the HAG.
- E3. Attached garage (top of slab) is _____ feet meters above or below the HAG.
- E4. Top of platform of machinery and/or equipment servicing the building is _____ feet meters above or below the HAG.
- E5. Zone AO only: If no flood depth number is available, is the top of the bottom floor elevated in accordance with the community's floodplain management ordinance? Yes No Unknown. The local official must certify this information in Section G.

SECTION F - PROPERTY OWNER (OR OWNER'S REPRESENTATIVE) CERTIFICATION

The property owner or owner's authorized representative who completes Sections A, B, and E for Zone A (without a FEMA-issued or community-issued BFE) or Zone AO must sign here. The statements in Sections A, B, and E are correct to the best of my knowledge.

Property Owner's or Owner's Authorized Representative's Name _____

Address _____ City _____ State _____ ZIP Code _____

Signature _____ Date _____ Telephone _____

Comments _____

Check here if attachments

SECTION G - COMMUNITY INFORMATION (OPTIONAL)

The local official who is authorized by law or ordinance to administer the community's floodplain management ordinance can complete Sections A, B, C (or E), and G of this Elevation Certificate. Complete the applicable item(s) and sign below. Check the measurement used in Items G8 and G9.

- G1. The information in Section C was taken from other documentation that has been signed and sealed by a licensed surveyor, engineer, or architect who is authorized by law to certify elevation information. (Indicate the source and date of the elevation data in the Comments area below.)
- G2. A community official completed Section E for a building located in Zone A (without a FEMA-issued or community-issued BFE) or Zone AO.
- G3. The following information (Items G4-G9,) is provided for community floodplain management purposes.

G4. Permit Number	G5. Date Permit Issued	G6. Date Certificate Of Compliance/Occupancy Issued
-------------------	------------------------	---

G7. This permit has been issued for: New Construction Substantial Improvement

G8. Elevation of as-built lowest floor (including basement) of the building: feet meters (PR) Datum _____

G9. BFE or (in Zone AO) depth of flooding at the building site: feet meters (PR) Datum _____

Local Official's Name _____ Title _____

Community Name _____ Telephone _____

Signature _____ Date _____

Comments _____

Check here if attachments

Building Photographs

See Instructions for Item A6.

Building Street Address (Including Apt., Unit, Suite, and/or Bldg. No.) or P.O. Route and Box No. 205 COLLINS RD		For Insurance Company Use: Policy Number	
City NOKOMIS	State FLORIDA	ZIP Code 34275	Company NAIC Number

If using the Elevation Certificate to obtain NFIP flood insurance, affix at least two building photographs below according to the instructions for Item A6. Identify all photographs with: date taken; "Front View" and "Rear View"; and, if required, "Right Side View" and "Left Side View." If submitting more photographs than will fit on this page, use the Continuation Page, following.



FRONT 06/27/08

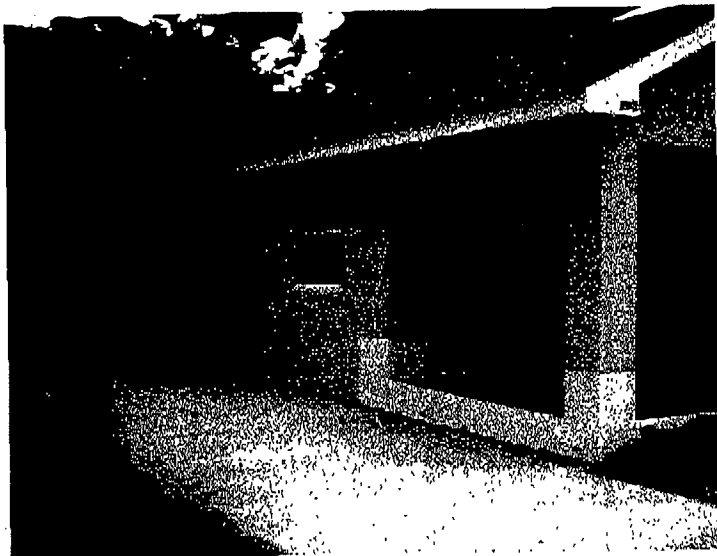

LEFT SIDE 06/27/08



RIGHT SIDE 06/27/08

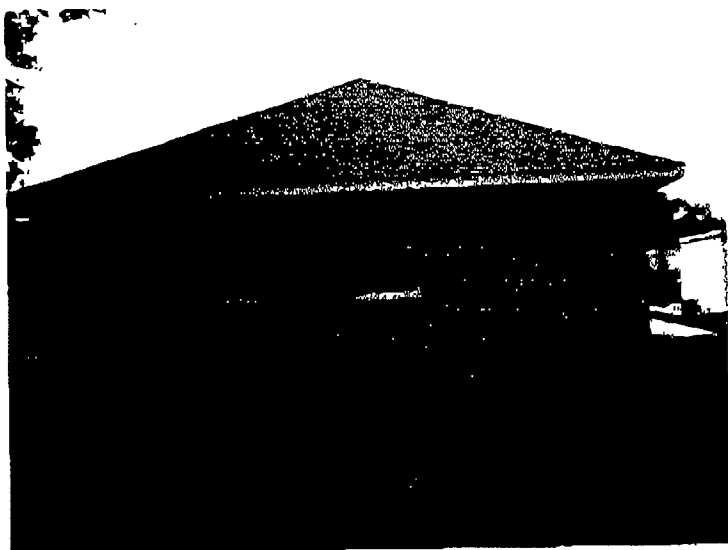

REAR 06/27/08