

ELEVATION CERTIFICATE

OMB No. 1660-0008
Expires February 28, 2009

Important: Read the instructions on pages 1-8.

3rd Q 06
0486-07-0011

05 430 491

SECTION A - PROPERTY INFORMATION

Building Owner's Name JAN G. KEITH, TRUST		For Insurance Company Use: Policy Number	
A2. Building Street Address (including Apt., Unit, Suite, and/or Bldg. No.) or P.O. Route and Box No. 10313 HEBBLEWHITE COURT		Company NAIC Number	
City ENGLEWOOD	State FLORIDA	ZIP Code 34223	
A3. Property Description (Lot and Block Numbers, Tax Parcel Number, Legal Description, etc.) LOT 20, HEBBLEWHITE COURT			
A4. Building Use (e.g., Residential, Non-Residential, Addition, Accessory, etc.) RESIDENTIAL			
A5. Latitude/Longitude: Lat. 26° 53' 47.3" Long. 82° 22' 26.9" (##° -##' -###" or ###.###") Horizontal Datum: <input type="checkbox"/> NAD 1927 <input checked="" type="checkbox"/> NAD 1983			
A6. Attach at least 2 photographs of the building if the Certificate is being used to obtain flood insurance.			
A7. Building Diagram Number 1			
A8. For a building with a crawl space or enclosure(s), provide: a) Square footage of crawl space or enclosure(s) 0 sq ft a) b) No. of permanent flood openings in the crawl space or enclosure(s) walls within 1.0 foot above adjacent grade 0 c) Total net area of flood openings in A8.b 0 sq in c)		A9. For a building with an attached garage, provide: Square footage of attached garage 473 sq ft b) No. of permanent flood openings in the attached garage walls within 1.0 foot above adjacent grade 0 Total net area of flood openings in A9.b 0 sq in	

SECTION B - FLOOD INSURANCE RATE MAP (FIRM) INFORMATION

B1. NFIP Community Name & Community Number SARASOTA COUNTY, FLORIDA 125144		B2. County Name SARASOTA		B3. State FLORIDA	
B4. Map/Panel Number 125144 0451	B5. Suffix D	B6. FIRM Index Date SEPT 3, 1992	B7. FIRM Panel Effective/Revised Date MAY 1, 1984	B8. Flood Zone(s) A12	B9. Base Flood Elevation(s) (Zone AO, use base flood depth) 12'
B10. Indicate the source of the Base Flood Elevation (BFE) data or base flood depth entered in Item B9. <input type="checkbox"/> FIS Profile <input checked="" type="checkbox"/> FIRM <input type="checkbox"/> Community Determined <input type="checkbox"/> Other (Describe) _____					
B11. Indicate elevation datum used for BFE in Item B9: <input checked="" type="checkbox"/> NGVD 1929 <input type="checkbox"/> NAVD 1988 <input type="checkbox"/> Other (Describe) _____					
Is the building located in a Coastal Barrier Resources System (CBRS) area or Otherwise Protected Area (OPA)? <input type="checkbox"/> Yes <input checked="" type="checkbox"/> No Designation Date N/A <input type="checkbox"/> CBRS <input type="checkbox"/> OPA					

SECTION C - BUILDING ELEVATION INFORMATION (SURVEY REQUIRED)

C1. Building elevations are based on: Construction Drawings* Building Under Construction* Finished Construction
*A new Elevation Certificate will be required when construction of the building is complete.

C2. Elevations - Zones A1-A30, AE, AH, A (with BFE), VE, V1-V30, V (with BFE), AR, AR/A, AR/AE, AR/A1-A30, AR/AH, AR/AO. Complete Items C2.a-g below according to the building diagram specified in Item A7.

Benchmark Utilized **SARCO BM #484** Vertical Datum **NGVD 1929**
Conversion/Comments **N/A**

a) Top of bottom floor (including basement, crawl space, or enclosure floor)	15.8	<input checked="" type="checkbox"/> feet	<input type="checkbox"/> meters (Puerto Rico only)
b) Top of the next higher floor	N/A	<input checked="" type="checkbox"/> feet	<input type="checkbox"/> meters (Puerto Rico only)
c) Bottom of the lowest horizontal structural member (V Zones only)	N/A	<input checked="" type="checkbox"/> feet	<input type="checkbox"/> meters (Puerto Rico only)
d) Attached garage (top of slab)	16.3	<input checked="" type="checkbox"/> feet	<input type="checkbox"/> meters (Puerto Rico only)
e) Lowest elevation of machinery or equipment servicing the building (Describe type of equipment in Comments)	15.1	<input checked="" type="checkbox"/> feet	<input type="checkbox"/> meters (Puerto Rico only)
f) Lowest adjacent (finished) grade (LAG)	14.8	<input checked="" type="checkbox"/> feet	<input type="checkbox"/> meters (Puerto Rico only)
g) Highest adjacent (finished) grade (HAG)	15.1	<input checked="" type="checkbox"/> feet	<input type="checkbox"/> meters (Puerto Rico only)

SECTION D - SURVEYOR, ENGINEER, OR ARCHITECT CERTIFICATION

This certification is to be signed and sealed by a land surveyor, engineer, or architect authorized by law to certify elevation information. I certify that the information on this Certificate represents my best efforts to interpret the data available. I understand that any false statement may be punishable by fine or imprisonment under 18 U.S. Code, Section 1001.

Check here if comments are provided on back of form.

Certifier's Name RANDALL E. BRITT	License Number 3979
Company Name BRITT SURVEYING, INC.	
City VENICE	State FL
Date SEPT. 5, 2006	Telephone (941) 493-1366

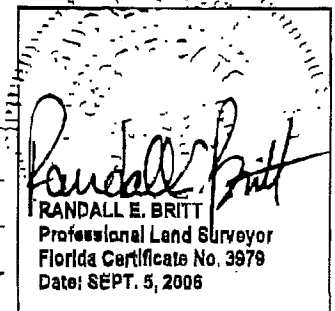

IMPORTANT: In these spaces, copy the corresponding information from Section A.

For Insurance Company Use:

Building Street Address (including Apt., Unit, Suite, and/or Bldg. No.) or P.O. Route and Box No.
10313 HEBBLEWHITE COURT

Policy Number

City
ENGLEWOOD

State
FLORIDA

ZIP Code
34223

Company NAIC Number

SECTION D - SURVEYOR, ENGINEER, OR ARCHITECT CERTIFICATION (CONTINUED) 05436491

Copy both sides of this Elevation Certificate for (1) community official, (2) insurance agent/company, and (3) building owner.

Comments ONE STORY CONCRETE BLOCK STRUCTURE

LOWEST ELEVATION OF MACHINERY SERVICING BUILDING - PAD FOR AC UNIT

Signature [Handwritten Signature]

Date
SEPT. 8, 2008

Check here if attachments

SECTION E - BUILDING ELEVATION INFORMATION (SURVEY NOT REQUIRED) FOR ZONE AO AND ZONE A (WITHOUT BFE)

For Zones AO and A (without BFE), complete items E1-E5. If the Certificate is intended to support a LOMA or LOMR-F request, complete Sections A, B, and C. For items E1-E4, use natural grade, if available. Check the measurement used. In Puerto Rico only, enter meters.

- E1. Provide elevation information for the following and check the appropriate boxes to show whether the elevation is above or below the highest adjacent grade (HAG) and the lowest adjacent grade (LAG).
a) Top of bottom floor (including basement, crawl space, or enclosure) is ... feet meters above or below the HAG.
b) Top of bottom floor (including basement, crawl space, or enclosure) is ... feet meters above or below the LAG.
E2. For Building Diagrams 6-8 with permanent flood openings provided in Section A Items 8 and/or 9 (see page 8 of Instructions), the next higher floor (elevation C2.b in the diagrams) of the building is ... feet meters above or below the HAG.
E3. Attached garage (top of slab) is ... feet meters above or below the HAG.
E4. Top of platform of machinery and/or equipment servicing the building is ... feet meters above or below the HAG.
E5. Zone AO only: If no flood depth number is available, is the top of the bottom floor elevated in accordance with the community's floodplain management ordinance? Yes No Unknown. The local official must certify this information in Section G.

SECTION F - PROPERTY OWNER (OR OWNER'S REPRESENTATIVE) CERTIFICATION

The property owner or owner's authorized representative who completes Sections A, B, and E for Zone A (without a FEMA-issued or community-issued BFE) or Zone AO must sign here. The statements in Sections A, B, and E are correct to the best of my knowledge.

Property Owner's or Owner's Authorized Representative's Name

Address City State ZIP Code

Signature Date Telephone

Comments

Check here if attachments

SECTION G - COMMUNITY INFORMATION (OPTIONAL)

The local official who is authorized by law or ordinance to administer the community's floodplain management ordinance can complete Sections A, B, C (or E), and G of this Elevation Certificate. Complete the applicable item(s) and sign below. Check the measurement used in Items G8, and G9.

- G1. The information in Section C was taken from other documentation that has been signed and sealed by a licensed surveyor, engineer, or architect who is authorized by law to certify elevation information. (Indicate the source and date of the elevation data in the Comments area below.)
G2. A community official completed Section E for a building located in Zone A (without a FEMA-issued or community-issued BFE) or Zone AO.
G3. The following information (Items G4.-G9.) is provided for community floodplain management purposes.

Table with 3 columns: G4. Permit Number, G5. Date Permit Issued, G6. Date Certificate Of Compliance/Occupancy Issued

G7. This permit has been issued for: New Construction Substantial Improvement

G8. Elevation of as-built lowest floor (including basement) of the building: feet meters (PR) Datum

G9. BFE or (in Zone AO) depth of flooding at the building site: feet meters (PR) Datum

Local Official's Name Title

Community Name Telephone

Signature Date

Comments

Check here if attachments